

Build BPS

Welcome to the Warren-Prescott School

March 9, 2016



**BOSTON
PUBLIC
SCHOOLS**
SY 2015 - 2016



BPS Timeline



Key

- EARLY EDUCATION CENTER
- ELEMENTARY
- ELEMENTARY/MIDDLE
- MIDDLE
- HIGH

School names and type represent the current BPS system

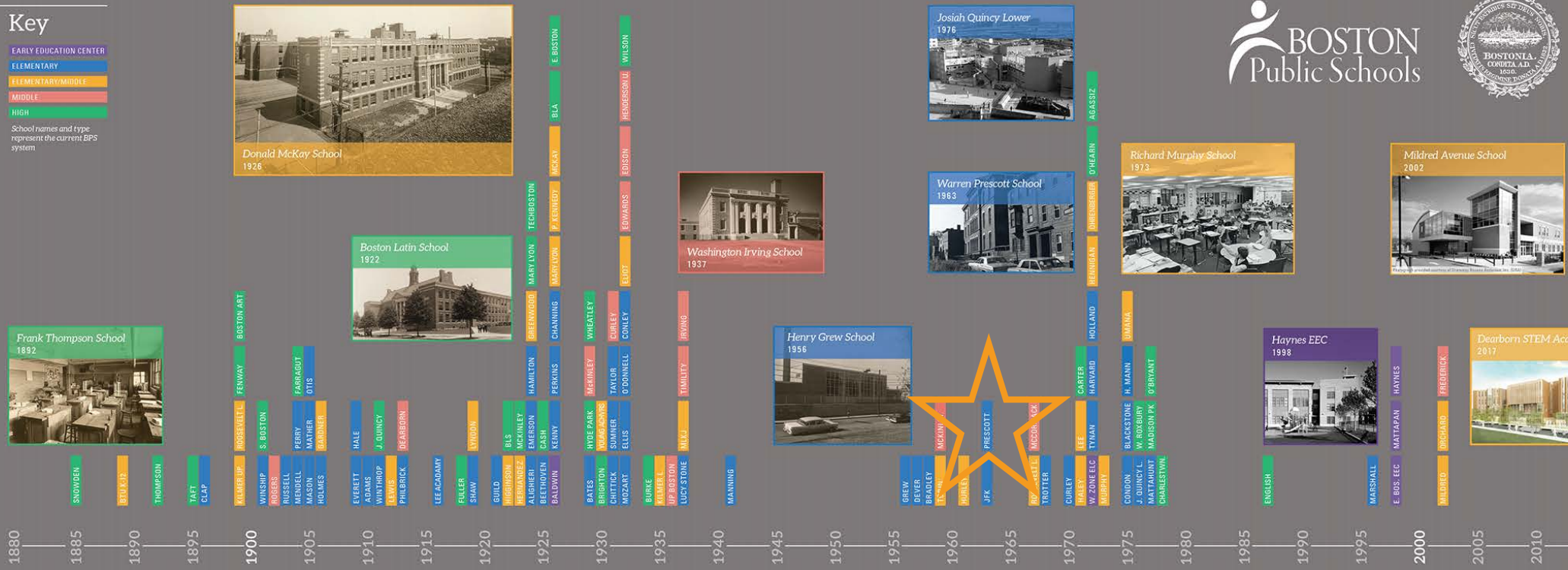

Build BPS

Boston Public Schools
Building History



Building Boston's Public Schools, One Story at a Time

SMMA

Agenda



Introductions

10 Year Facility and Educational Masterplan

Phase II Process

Physical Analysis Report

Educational Program Assessment Report

21st Century Educational Concepts & Spaces

Site and Neighborhood Discussion

Next Steps and Q&A

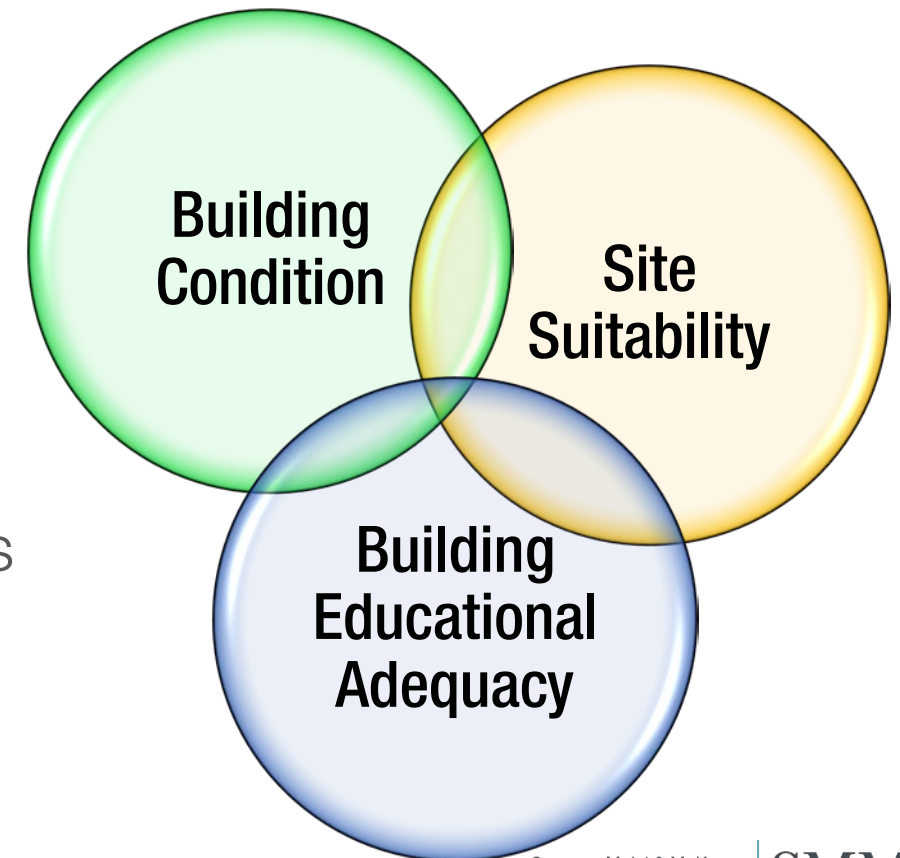

What's in the study?



- Demographics
- Facility Assessments
- Educational Adequacy Assessments
- Community Engagement
- Financial Planning

Community Outreach



- Survey
 - Parents
 - Teachers
 - Staff
 - Students
- Tool Kit for Each School (competitive)
- Neighborhood Discussion
- Community wide Engagement (by program)
 - Elementary School
 - Middle School
 - High School
- August: Superintendent's City Wide Event

What Assessments are ***NOT*** for



NOT rating the educational programs

NOT rating the educational performance of the schools

NOT rating the teachers of the school

NOT rating the community or neighborhood “*value*”

Facility Physical Assessment



Building and site investigations by professionals:

- Architect (Educational designer)

- Structural Engineer

- MEP Engineer

- Civil Engineer

10 Year Facility and Educational Masterplan

Criteria Evaluation Form

SCHOOL NAME: Warren / Prescott Elementary School

ID#: 350346

HISTORICAL BUILDING NAME: Warren / Prescott

SCHOOL ENROLLMENT: 542

BUILDING ENROLLMENT: 486

SITE VISIT DATE: 4/23/89

SCHOOL NAME: Warren / Prescott Elementary School

ID#: 350346

HISTORICAL SCHOOL NAME: Warren / Prescott

SITE VISIT DATE: 4/23/89

1 | Facility Evaluation Criteria

Physical Analysis:

Major investments in the last 20 years? (> \$5 Mil)

Rating Category
☒ Excellent ☒ Good ☐ Fair ☐ Poor ☐ Failing

☐ YES ☐ NO COMMENT: _____

Roof:

- Membrane
- Space on roof for solar

NEEDS ☐ Minor ☒ Moderate ☐ Major ☐ Replace ☐ N/A
☐ YES ☐ NO COMMENT: _____

Façade

NEEDS ☐ Minor ☒ Moderate ☐ Major ☐ Replace ☐ N/A

Windows

NEEDS ☐ Minor ☐ Moderate ☐ Major ☒ Replace ☐ N/A

Boilers

NEEDS ☒ Minor ☐ Moderate ☐ Major ☐ Replace ☐ N/A

Heating Distribution Systems

NEEDS ☒ Minor ☐ Moderate ☐ Major ☐ Replace ☐ N/A

Ventilation Distribution Systems

NEEDS ☐ Minor ☐ Moderate ☐ Major ☐ Replace ☒ N/A

Electrical Service

NEEDS ☐ Minor ☐ Moderate ☐ Major ☒ Replace ☐ N/A

Existing Photovoltaics

☐ YES ☒ NO COMMENT: _____

Life Safety:

- Means of Egress
- Fire Protection (sprinklers)
- Fire Alarm

NEEDS ☒ Minor ☐ Moderate ☐ Major ☐ Replace ☐ N/A
 NEEDS ☐ Minor ☐ Moderate ☒ Major ☐ Replace ☐ N/A
 NEEDS ☒ Minor ☐ Moderate ☐ Major ☐ Replace ☐ N/A

Security:

- Entry Sequence

NEEDS ☐ Minor ☒ Moderate ☐ Major ☐ Replace ☐ N/A

Lighting Quantity/Control

NEEDS ☐ Minor ☒ Moderate ☐ Major ☐ Replace ☐ N/A

Toilets & Fixtures

NEEDS ☒ Minor ☐ Moderate ☐ Major ☐ Replace ☐ N/A

Plumbing Distribution Systems

NEEDS ☒ Minor ☐ Moderate ☐ Major ☐ Replace ☐ N/A

Accessibility

NEEDS ☐ Minor ☐ Moderate ☐ Major ☒ Replace ☐ N/A

Structural System:

Signs of Deterioration:

- Roof
- Floor
- Walls/Columns
- Foundations
- Façade

☐ YES ☒ Not Observed COMMENT: _____
☐ YES ☒ Not Observed COMMENT: _____
☒ YES ☐ Not Observed COMMENT: Significant crack in stairwell, major
☐ YES ☒ Not Observed COMMENT: _____
☒ YES ☐ Not Observed COMMENT: Spalled concrete on exterior column
☐ YES ☒ Not Observed COMMENT: _____

Is the lateral system identifiable?

☐ YES ☒ Not Observed COMMENT: _____

Overall Building Condition

☐ Excellent ☐ Good ☐ Fair ☐ Poor ☐ Failing

Community:

Mass Historical Commission Status:

- Inventory of Historic Assets
- State Register of Historic Places

☐ Listed ☒ Not Listed COMMENT: _____
☐ Listed ☒ Not Listed COMMENT: _____

Emergency Shelter

☐ YES ☐ NO COMMENT: _____

Community Use Spaces

☐ YES ☐ NO COMMENT: _____

Community Building Rating

☐ Excellent ☐ Good ☐ Fair ☐ Poor ☐ Failing

Building suitability for school use?

☐ YES ☐ NO COMMENT: _____

2 | Site Evaluation Criteria

Physical Analysis:

Is the site susceptible to climate change?

☐ YES ☒ NO BY 2100 ☐ YES ☒ NO

Major investments in the last 10 years? (> \$5 Mil)

☐ YES ☒ NO COMMENT: _____

Is the building expandable on current site?

☐ YES ☒ NO COMMENT: _____

Is the site expandable?

☐ YES ☒ NO COMMENT: _____

Parking Quality

NEEDS BY 2050 ☐ Minor ☐ Moderate ☒ Major ☐ Replace ☐ N/A

Neighborhood Streets

NEEDS ☐ Minor ☒ Moderate ☐ Major ☐ Replace ☐ N/A

Drop Off/Pick Up Routes

NEEDS ☒ Minor ☐ Moderate ☐ Major ☐ Replace ☐ N/A

Walkways/Curbs/Sidewalks

NEEDS ☐ Minor ☐ Moderate ☒ Major ☐ Replace ☐ N/A

MAAB/ADA Accessibility

NEEDS ☐ Minor ☐ Moderate ☒ Major ☐ Replace ☐ N/A

Site Lighting

NEEDS ☐ Minor ☐ Moderate ☐ Major ☒ Replace ☐ N/A

Fencing

NEEDS ☐ Minor ☒ Moderate ☐ Major ☐ Replace ☐ N/A

Drainage

NEEDS ☐ Minor ☐ Moderate ☒ Major ☐ Replace ☐ N/A

Play areas

NEEDS ☐ Minor ☐ Moderate ☒ Major ☐ Replace ☐ N/A

Walls/Slopes

NEEDS ☐ Minor ☒ Moderate ☐ Major ☐ Replace ☐ N/A

Overall Site Condition

☐ Excellent ☐ Good ☐ Fair ☒ Poor ☐ Failing

Community:

Mass Historical Commission Status

☐ Listed ☒ Not Listed

- Inventory of Archeological Assets

☐ YES ☐ NO COMMENT: Not yet researched
☒ YES ☐ NO COMMENT: 0.4 mi to Community College sta. / #92 & 93 buses nearby

Accessible to Mass Transit?

☐ YES ☒ NO COMMENT: Hilltop & narrow sidewalks

Bikable?

☐ YES ☒ NO COMMENT: Well connected neighborhood

Walkable?

☒ YES ☐ NO COMMENT: Well connected neighborhood

Community Site Rating

☐ Excellent ☐ Good ☐ Fair ☐ Poor ☐ Failing

Site suitability for school use?

☐ YES ☐ NO COMMENT: _____

Facility Physical Assessment



Building and site investigations by professionals:

- Architect (Educational designer)

- Structural Engineer

- MEP Engineer

- Civil Engineer

10 Year Facility and Educational Masterplan

Educational Vision



- Engaged Learning
- Differentiated and Personalized Learning
- Cognitively Demanding Tasks/Programs
- Equitable Access to Rigorous Curriculum
- Vision of 21st Century Digital Learning

Existing Conditions

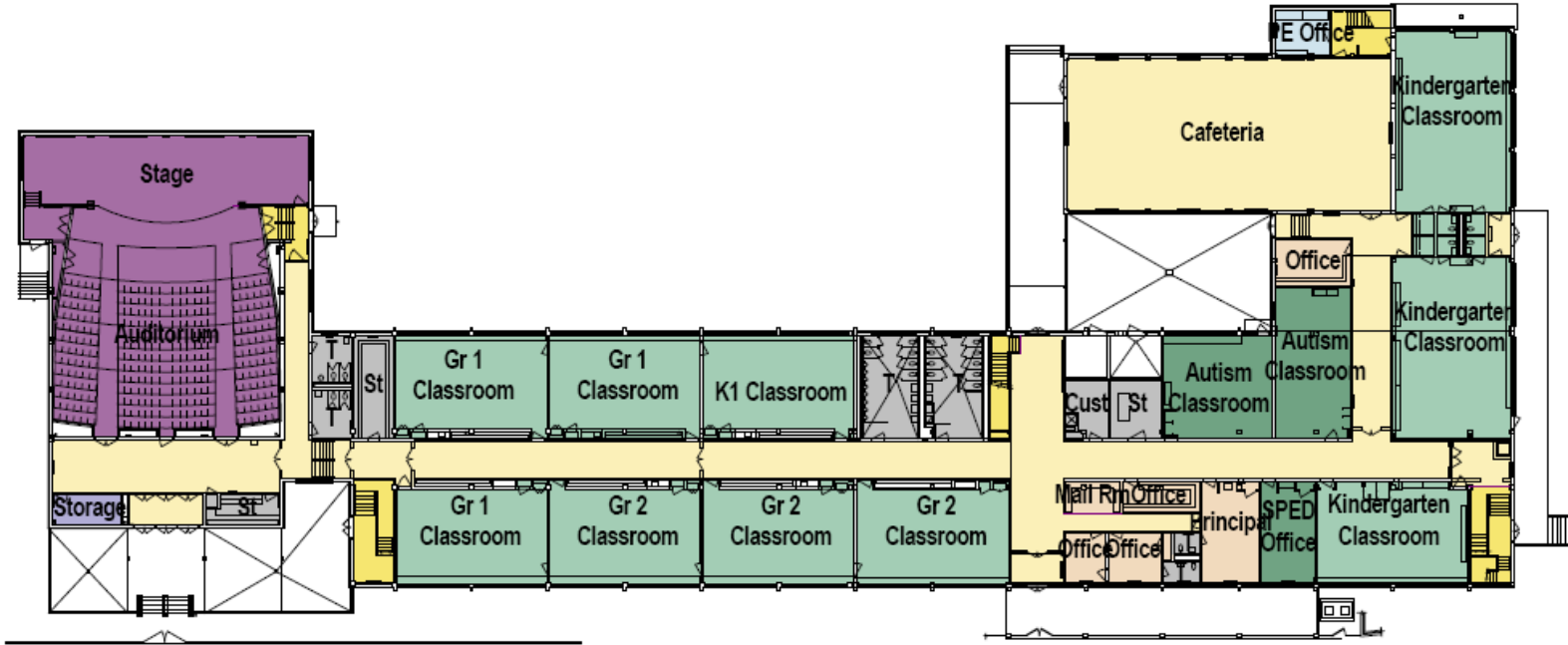

PROGRAM PLAN LEGEND

- ADMINISTRATION / GUIDANCE / STUDENT SERVICES / NURSE
- ART & MUSIC
- AUDITORIUM / PERFORMING ARTS & DRAMA
- CAFETERIA & CIRCULATION
- CLASSROOM & GENERAL EDUCATION SUPPORT
- CUSTODIAL / MAINTENANCE / STORAGE
- HEALTH & FITNESS
- SPECIAL EDUCATION
- VERTICAL CIRCULATION

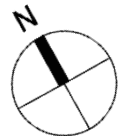

Existing Conditions

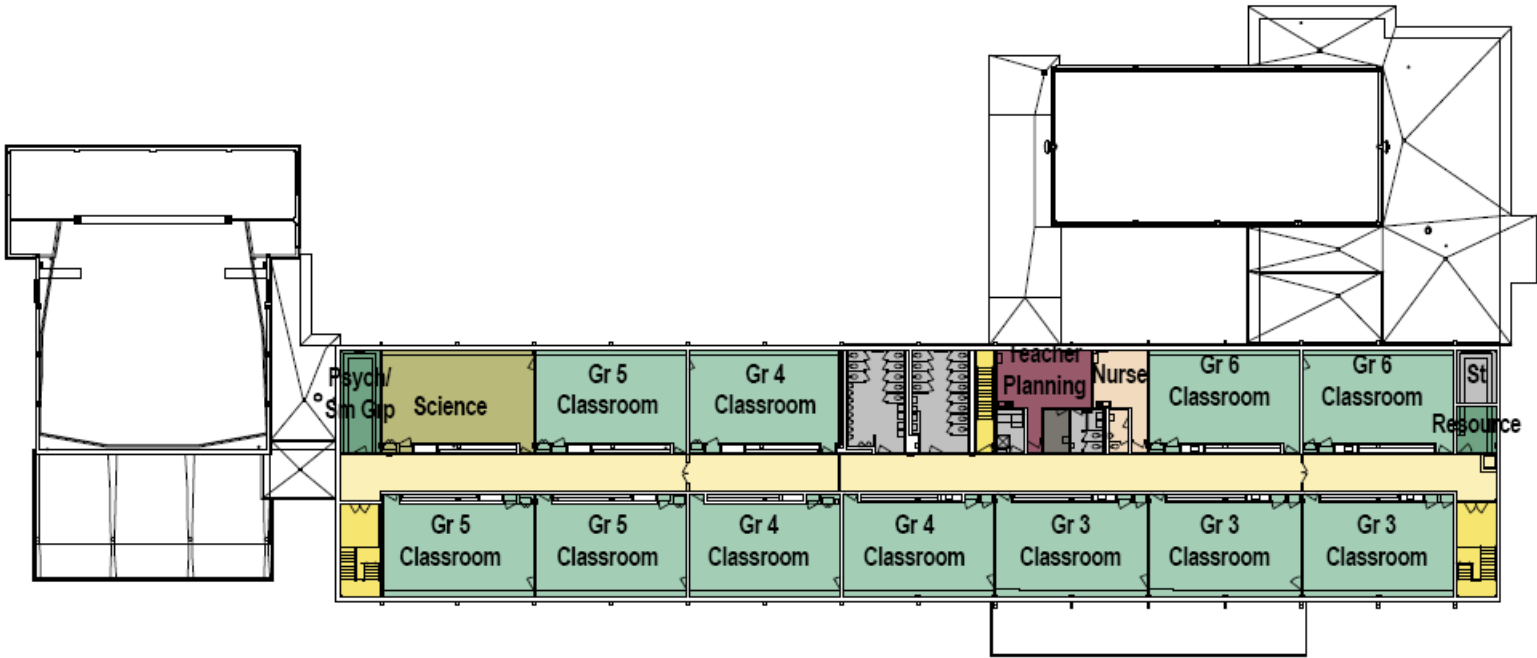

PROGRAM PLAN LEGEND

- ADMINISTRATION / GUIDANCE / STUDENT SERVICES / NURSE
- BUILDING EQUIPMENT
- CAFETERIA & CIRCULATION
- CLASSROOM & GENERAL EDUCATION SUPPORT
- CUSTODIAL / MAINTENANCE / STORAGE
- SCIENCE CLASSROOM & SUPPORT
- SPECIAL EDUCATION
- TEACHER PLANNING & SUPPORT
- VERTICAL CIRCULATION

Criteria Evaluation Form

SCHOOL NAME: WARREN/PRESCOTT K-8

ID#: 00350346

4 | Elementary: Pre-K to 8

Room Type	Quantity	MSBA Area	Actual Area	Adequacy		
Pre-K:	1	1200	825	<input checked="" type="checkbox"/> Good	<input type="checkbox"/> Fair	<input type="checkbox"/> Poor
Kindergarten	3	1200	1140	<input checked="" type="checkbox"/> Good	<input type="checkbox"/> Fair	<input type="checkbox"/> Poor
Classroom (General Education) Gr. 1-5	15	950	825	<input checked="" type="checkbox"/> Good	<input type="checkbox"/> Fair	<input type="checkbox"/> Poor
Classroom (General Education) Gr. 6-8	2	950	825	<input checked="" type="checkbox"/> Good	<input type="checkbox"/> Fair	<input type="checkbox"/> Poor
Science	1	1200	825	<input checked="" type="checkbox"/> Good	<input type="checkbox"/> Fair	<input type="checkbox"/> Poor
Special Education						
• Self Contained	2	950	640	<input checked="" type="checkbox"/> Good	<input type="checkbox"/> Fair	<input type="checkbox"/> Poor
• Resource of Small Group	1	500	105	<input checked="" type="checkbox"/> Good	<input type="checkbox"/> Fair	<input type="checkbox"/> Poor
Art Classroom Gr. 1-5		1200	0	<input checked="" type="checkbox"/> Good	<input type="checkbox"/> Fair	<input type="checkbox"/> Poor
Art Classroom Gr. 6-8		1500	0	<input checked="" type="checkbox"/> Good	<input type="checkbox"/> Fair	<input type="checkbox"/> Poor
Music Classroom		1200	0	<input checked="" type="checkbox"/> Good	<input type="checkbox"/> Fair	<input type="checkbox"/> Poor
Vocation and Technology			0	<input checked="" type="checkbox"/> Good	<input type="checkbox"/> Fair	<input type="checkbox"/> Poor
Gymnasium		6000	0	<input checked="" type="checkbox"/> Good	<input type="checkbox"/> Fair	<input type="checkbox"/> Poor
Media Center			0	<input checked="" type="checkbox"/> Good	<input type="checkbox"/> Fair	<input type="checkbox"/> Poor
Dining	1	4088	2766	<input checked="" type="checkbox"/> Good	<input type="checkbox"/> Fair	<input type="checkbox"/> Poor
• Stage	1	1000	1345	<input checked="" type="checkbox"/> Good	<input type="checkbox"/> Fair	<input type="checkbox"/> Poor
Medical				<input checked="" type="checkbox"/> Good	<input type="checkbox"/> Fair	<input type="checkbox"/> Poor
Administration & Guidance		2835	783	<input checked="" type="checkbox"/> Good	<input type="checkbox"/> Fair	<input type="checkbox"/> Poor
Custodial/Maintenance	1	2119	812	<input checked="" type="checkbox"/> Good	<input type="checkbox"/> Fair	<input type="checkbox"/> Poor
• AC Tech Network Room		200		<input checked="" type="checkbox"/> Good	<input type="checkbox"/> Fair	<input type="checkbox"/> Poor
Other						
• Computer Lab		0		<input checked="" type="checkbox"/> Good	<input type="checkbox"/> Fair	<input type="checkbox"/> Poor
• Community Space				<input checked="" type="checkbox"/> Good	<input type="checkbox"/> Fair	<input type="checkbox"/> Poor

Narrative on: AUDITORIUM 2585

- Engaged Learning
- Differentiated Learning
- Cognitively demanding tasks/programs
- Equitable access to a rigorous curriculum
- Vision of 21st Century digital learning

Comments:

Elementary Music

1,200 SF
Acoustically isolated
Acoustically appropriate



OT /PT



Resource Rooms & Small Group Rooms
vary from 500 – 1,000 Nsf

Criteria Evaluation Form

SCHOOL NAME: WARREN/PRESCOTT K-8

ID#: 00350346

4 | Elementary: Pre-K to 8

Room Type	Quantity	MSBA Area	Actual Area	Adequacy		
Pre-K:	1	1200	825	<input checked="" type="checkbox"/> Good	<input type="checkbox"/> Fair	<input type="checkbox"/> Poor
Kindergarten	3	1200	1140	<input checked="" type="checkbox"/> Good	<input type="checkbox"/> Fair	<input type="checkbox"/> Poor
Classroom (General Education) Gr. 1-5	15	950	825	<input checked="" type="checkbox"/> Good	<input type="checkbox"/> Fair	<input type="checkbox"/> Poor
Classroom (General Education) Gr. 6-8	2	950	825	<input checked="" type="checkbox"/> Good	<input type="checkbox"/> Fair	<input type="checkbox"/> Poor
Science	1	1200	825	<input checked="" type="checkbox"/> Good	<input type="checkbox"/> Fair	<input type="checkbox"/> Poor
Special Education						
• Self Contained	2	950	640	<input checked="" type="checkbox"/> Good	<input type="checkbox"/> Fair	<input type="checkbox"/> Poor
• Resource of Small Group	1	500	105	<input checked="" type="checkbox"/> Good	<input type="checkbox"/> Fair	<input type="checkbox"/> Poor
Art Classroom Gr. 1-5		1200	0	<input checked="" type="checkbox"/> Good	<input type="checkbox"/> Fair	<input type="checkbox"/> Poor
Art Classroom Gr. 6-8		1500	0	<input checked="" type="checkbox"/> Good	<input type="checkbox"/> Fair	<input type="checkbox"/> Poor
Music Classroom		1200	0	<input checked="" type="checkbox"/> Good	<input type="checkbox"/> Fair	<input type="checkbox"/> Poor
Vocation and Technology			0	<input checked="" type="checkbox"/> Good	<input type="checkbox"/> Fair	<input type="checkbox"/> Poor
Gymnasium		6000	0	<input checked="" type="checkbox"/> Good	<input type="checkbox"/> Fair	<input type="checkbox"/> Poor
Media Center		3000	0	<input checked="" type="checkbox"/> Good	<input type="checkbox"/> Fair	<input type="checkbox"/> Poor
Dining	1	4088	2766	<input checked="" type="checkbox"/> Good	<input type="checkbox"/> Fair	<input type="checkbox"/> Poor
• Stage	1	1000	1345	<input checked="" type="checkbox"/> Good	<input type="checkbox"/> Fair	<input type="checkbox"/> Poor
Medical				<input checked="" type="checkbox"/> Good	<input type="checkbox"/> Fair	<input type="checkbox"/> Poor
Administration & Guidance		2835	783	<input checked="" type="checkbox"/> Good	<input type="checkbox"/> Fair	<input type="checkbox"/> Poor
Custodial/Maintenance	1	2119 1900	812	<input checked="" type="checkbox"/> Good	<input type="checkbox"/> Fair	<input type="checkbox"/> Poor
• AC Tech Network Room		200		<input checked="" type="checkbox"/> Good	<input type="checkbox"/> Fair	<input type="checkbox"/> Poor
Other						
• Computer Lab		0		<input checked="" type="checkbox"/> Good	<input type="checkbox"/> Fair	<input type="checkbox"/> Poor
• Community Space				<input checked="" type="checkbox"/> Good	<input type="checkbox"/> Fair	<input type="checkbox"/> Poor

Narrative on:

- Engaged Learning
- Differentiated Learning
- Cognitively demanding tasks/programs
- Equitable access to a rigorous curriculum
- Vision of 21st Century digital learning

Comments:

AUDITORIUM 2585

Learning Commons/Media Center



Fielding Nair International, Architects

Elementary Art

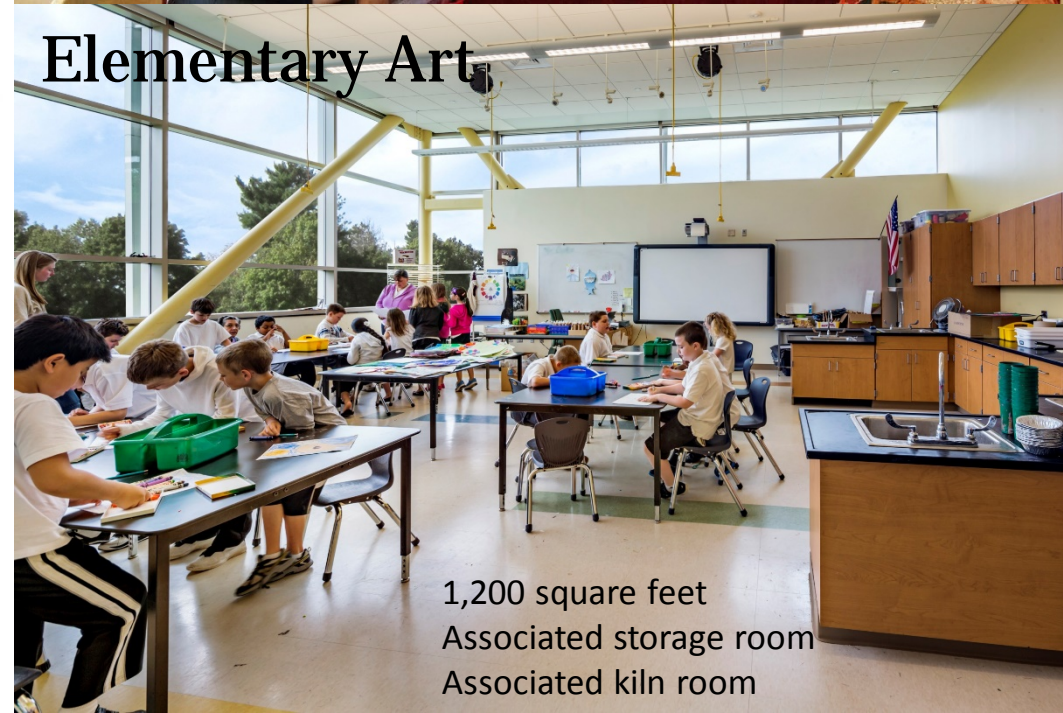

1,200 square feet
Associated storage room
Associated kiln room

MSBA Space Summary

Warren/Prescott K-8		Existing Conditions	MSBA Guidelines (refer to MSBA Educational Program & Space Standard Guidelines)	
ROOM TYPE	area totals	% Deficient/ Undersized	area totals	Comments
CORE ACADEMIC SPACES	19,197	-26%	25,780	
SPECIAL EDUCATION	1,616	-73%	6,040	
ART & MUSIC	113	-98%	5,625	
VOCATIONS & TECHNOLOGY	0	-100%	3,200	
HEALTH & PHYSICAL EDUCATION	142	-98%	8,321	
MEDIA CENTER	0	-100%	3,204	
DINING & FOOD SERVICE	4,112	-50%	8,150	
MEDICAL	267	-56%	610	
ADMINISTRATION & GUIDANCE	783	-72%	2,835	
CUSTODIAL & MAINTENANCE	812	-62%	2,119	
OTHER	0		0	
Total Building Net Floor Area (NFA)	27,042	-59%	65,885	
Proposed Student Capacity / Enrollment	223	-59%	545	Enter grade enrollments to the right
Total Building Gross Floor Area (GFA) ²	59,330	-40%	98,827	
Grossing factor (GFA/NFA)	2.19	46%	1.50	

Grades K-5	79%
431	
Grades 6-8	21%
114	

* Warren/Prescott School current leases space adjacent to school site for grades 7 and 8. That space was not considered in this evaluation.

Existing Conditions

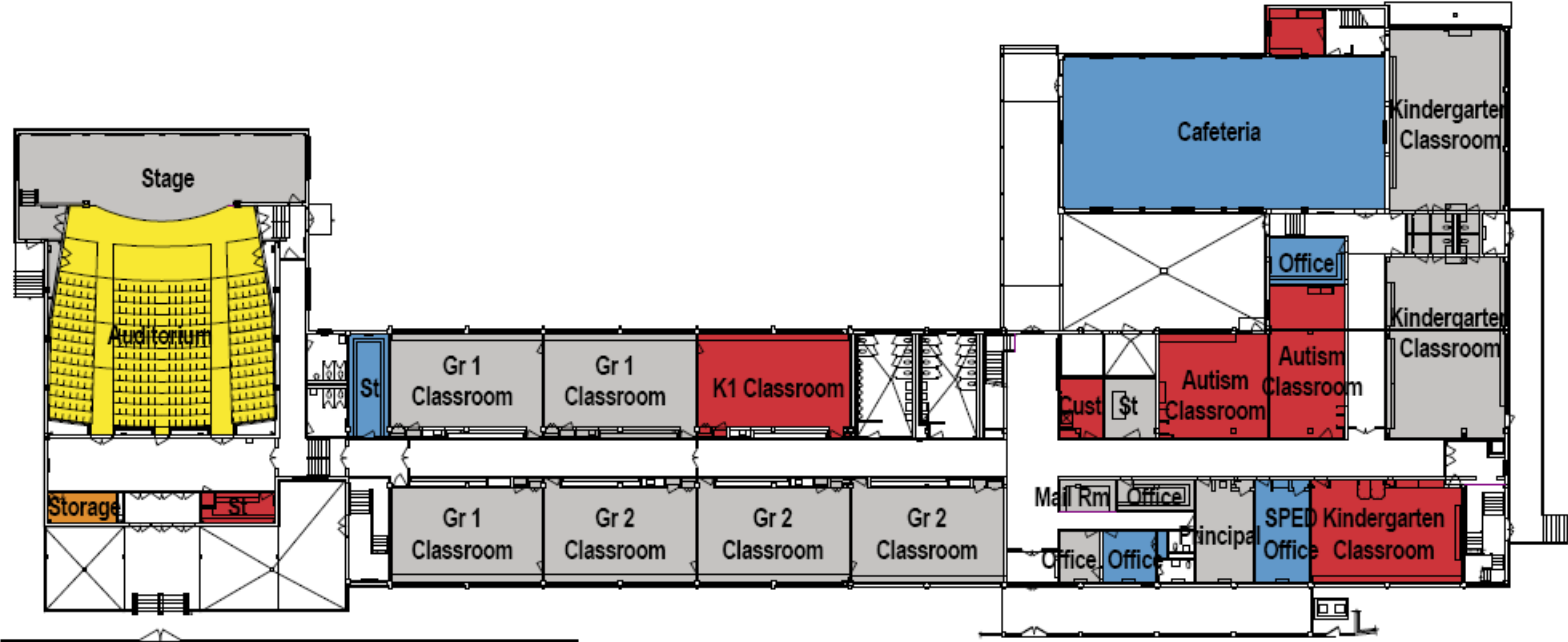

MSBA DEFICIENCY PLAN

- INAPPROPRIATE LOCATION OR ADJACENCY
- NOT INCLUDED IN A TYPICAL MSBA PROJECT
- NSF 10% GREATER THAN MSBA GUIDELINES
- NSF AT LEAST 20% LESS THAN MSBA GUIDELINES
- NSF MEETS MSBA GUIDELINES (-20% TO +10%)

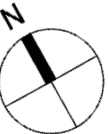

Existing Conditions

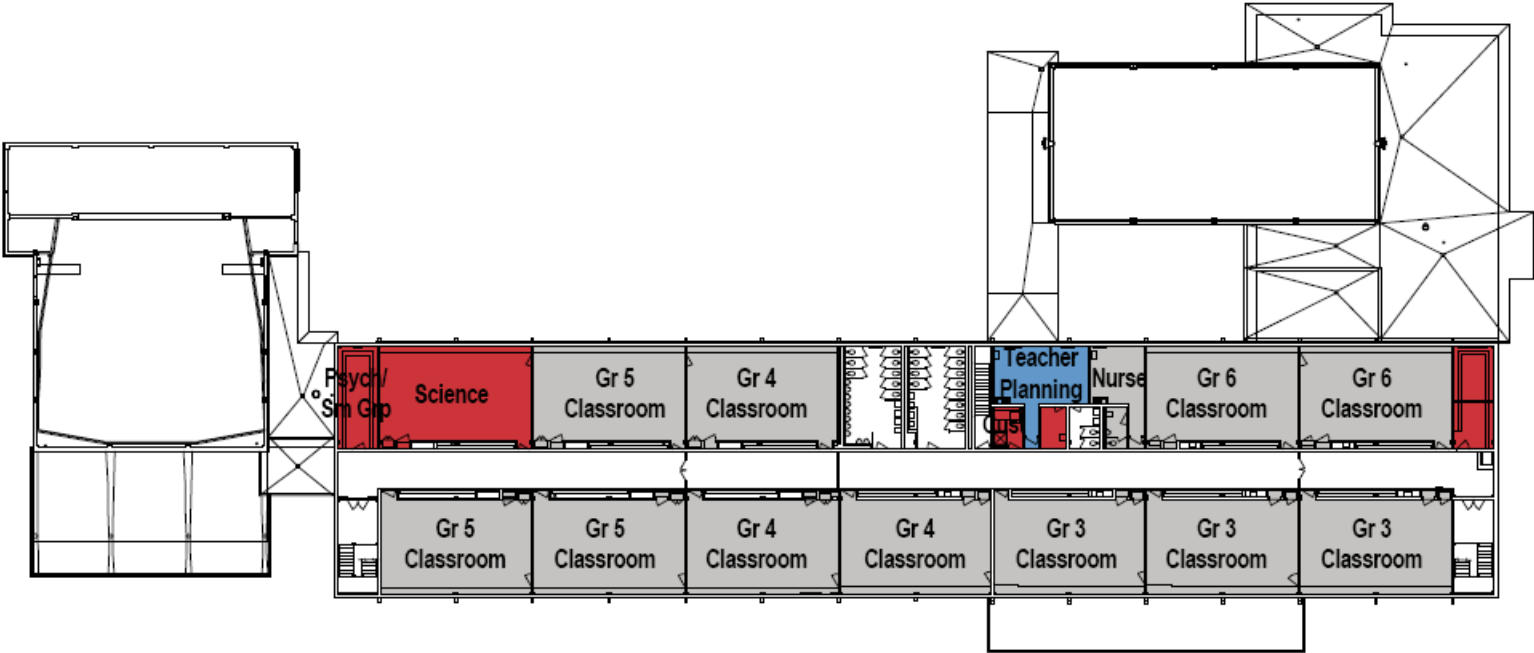

MSBA DEFICIENCY PLAN

- NSF 10% GREATER THAN MSBA GUIDELINES
- NSF AT LEAST 20% LESS THAN MSBA GUIDELINES
- NSF MEETS MSBA GUIDELINES (-20% TO +10%)

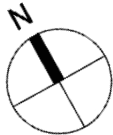

Neighborhood
Warren-Prescott School

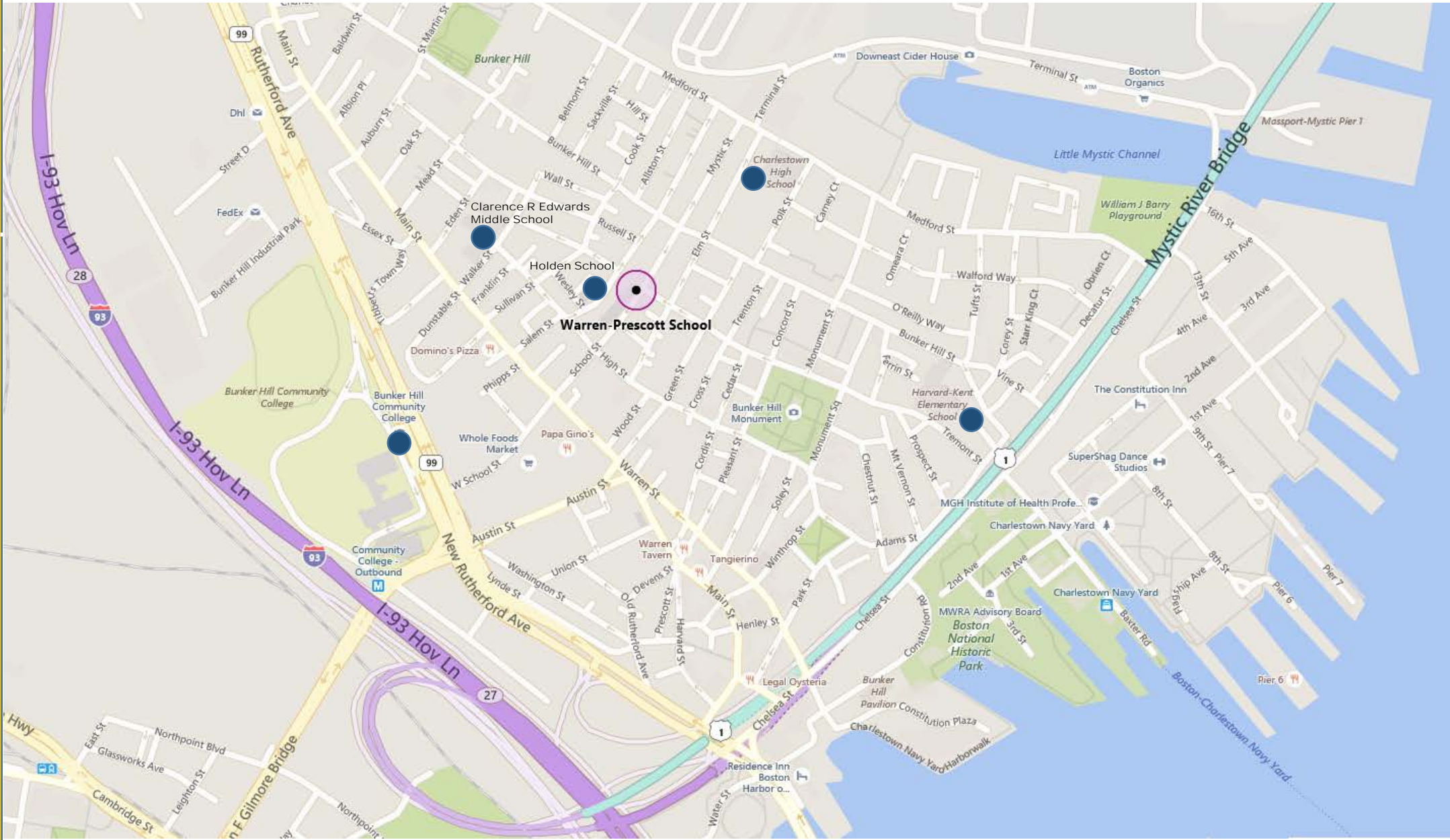

Neighborhood

Warren-Prescott School

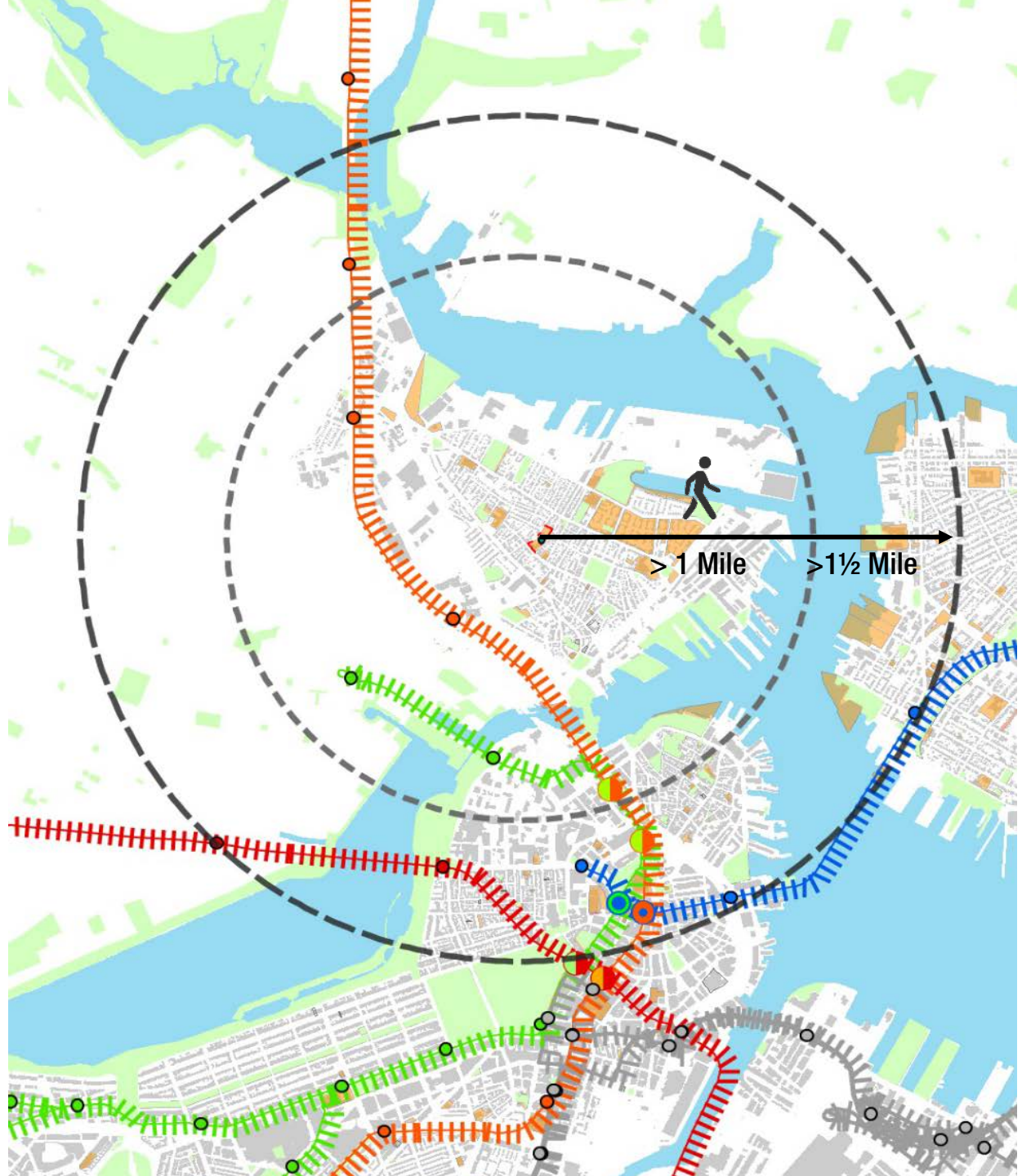

City Owned Parcels

Busing Policy Key

- >2mi High School T-Pass
- >1 1/2 mi 6th Grade & Below
- >K-8 up to 8th Grade
- >1mi Grades K-5

Transportation

- T Stops
- Bike Routes

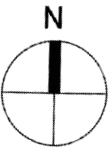



Warren-Prescott School Facility Needs

March 21, 2014



Discussion





Thank You

PRE-K - 8

Elementary Schools



Classroom Elements

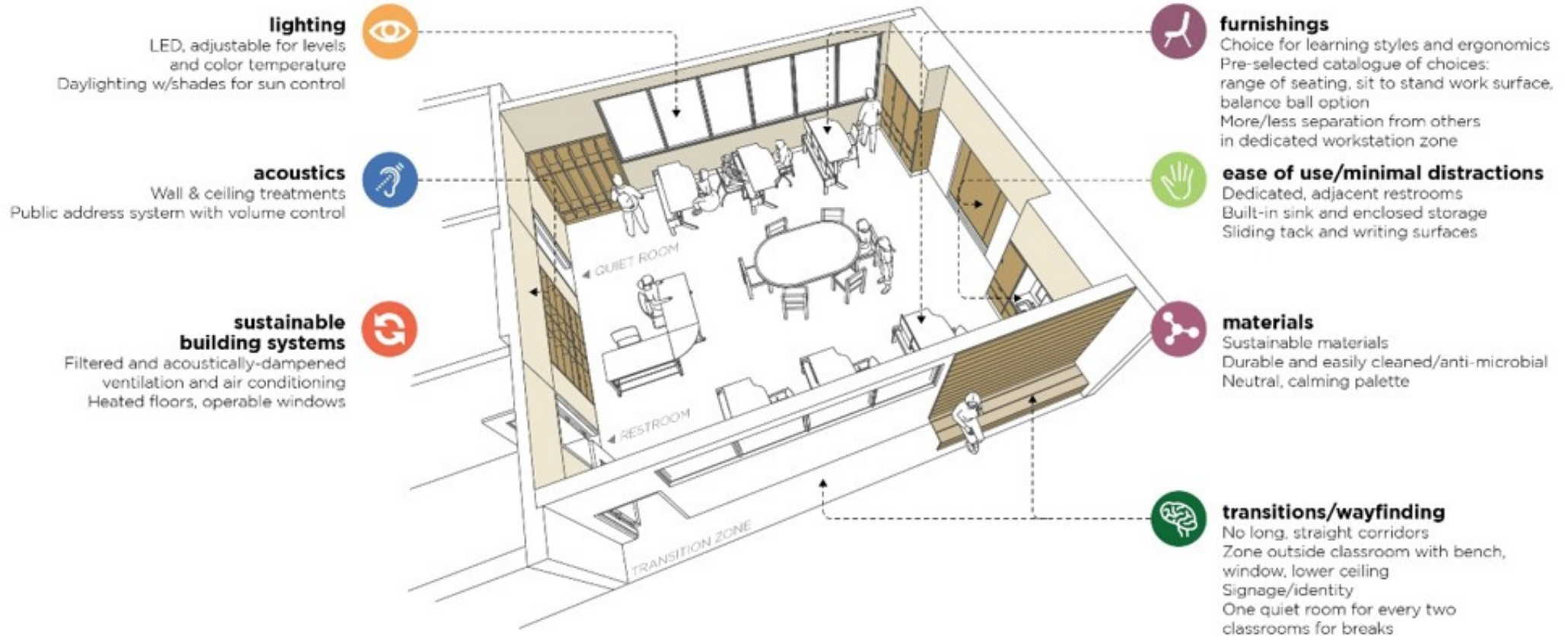

Contents

- Overview
- MSBA program and process
- Warren Prescott program and facility needs

Overview

- Overcrowding is already critical, and enrollment will continue to grow
 - Therapy, counseling and music already moved to storage rooms
 - Science and art will be moving to carts as their rooms become classrooms
- Extensive deferred maintenance has accumulated into a major project
- Warren-Prescott is an excellent fit with MSBA programs
- With needs and issues already identified, BPS and WP can make an MSBA submission in April

Facility issues already impair Warren-Prescott's ability to achieve its mission, and conditions will worsen

Scope of needs exceeds BPS resources, but is an excellent fit with the MSBA's programs

- The Massachusetts School Building Authority will fund up to 75% of repair and construction costs
- Warren Prescott's needs qualify on several MSBA criteria; one is enough to support a Statement of Interest (SOI)
 - Elimination of existing severe overcrowding.
 - Prevention of severe overcrowding expected to result from increased enrollments.
 - Replacement of or addition to obsolete buildings in order to provide for a full range of programs consistent with state and approved local requirements.
 - Replacement, renovation or modernization of school facility systems, such as roofs, windows, boilers, heating and ventilation systems, to increase energy conservation and decrease energy related costs in a school facility.

MSBA Needs Survey identified just fifteen Condition 3 or 4 schools within BPS

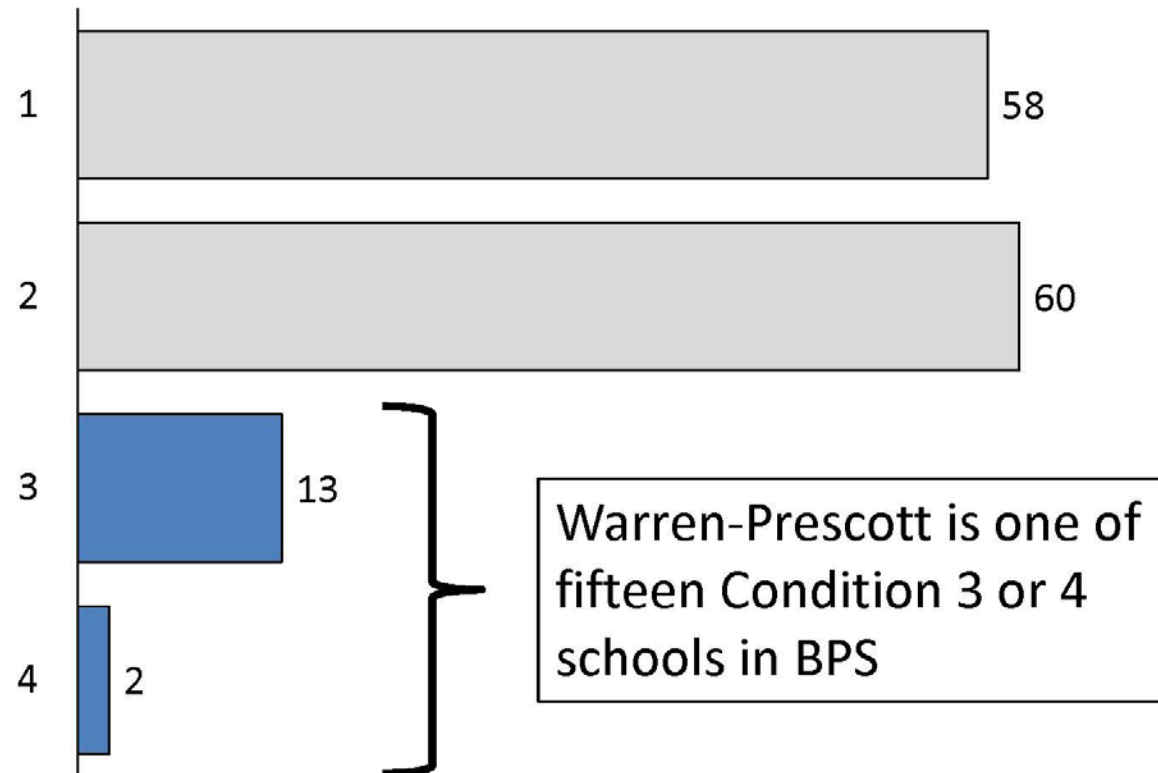

Source: 2010 MSBA Needs Survey

Warren-Prescott is one of the MSBA's fifteen Condition 3 or 4 schools within BPS

School Name	Type	Year	Renovated	Enrollment	SF / Student	Students / Classroom	Building Condition
Elihu Greenwood Elementary	ES	1957	-	347	147	19	3
Joseph P. Tynan Elementary	ES	1972	-	325	378	12	3
Mattahunt Elementary	ES	1972	-	559	320	10	3
Ralph Waldo Emerson Elementary	ES	1923	1988	243	96	20	3
Dorchester Academy‡	HS	1923	-	429	257	15	3
East Boston HS	HS	1924	2000	1,362	178	18	3
Madison Park Voc-Tech HS	HS	1977	2008	1,400	714	7	3
MS Academy	HS	1906	-	12	2342	1	3
TechBoston Upper Academy	HS	1923	-	283	257	12	3
William McKinley Preparatory HS	HS	1929	-	-	-	0	3
Warren/Prescott K-8 School	K-8	1963	-	452	131	20	3
Clarence R Edwards MS	MS	1932	-	496	159	12	3
Henry Dearborn MS	MS	1912	-	287	390	7	3
Holmes Elementary	ES	1906	-	279	226	14	4
Mather Elementary	ES	1905	-	549	153	12	4

Source: 2010 MSBA Needs Survey

MSBA Statement of Interest discusses issues and needs, not program or design

- The purpose of the Statement of Interest (SOI) is to outline the deficiencies (which are known for WP)
- The District is advised *not* to propose solutions in the SOI
- If the SOI is accepted, the MSBA and the District then work together to identify specific solutions:
 - Select project designer, project manager
 - Feasibility study, program needs
 - Schematic design
 - Detailed design

Warren-Prescott has already been identified as a high-priority school by MSBA, and constitutes a feasible project ready for SOI submission

Our facility needs are urgent

- Although our educational mission remains constant, our goals and objectives must adapt to the present and future needs of our students and society as a whole.
- The Warren-Prescott's space and facility needs make achieving those goals and objectives difficult and ultimately less effective, specifically in the areas of:
 - science, technology, physical education, and the arts
 - special needs, especially in our K-8 autistic programs

Crowding is already severe and will worsen



Storage rooms have become music practice rooms, therapy rooms, and teachers' offices. A corner of the stage is a classroom. Hallways are storage rooms. The science lab will be a cart.



Widespread repairs are needed and
minor structural issues should be addressed



Deferred maintenance needs are extensive



Current facilities have a range of issues

- Warren-Prescott is already overcrowded
 - Counseling and therapy (physical, occupational and speech) take place in storage rooms
 - Music and performing arts are taught in storage rooms, hallways or open spaces
 - Teachers without classrooms work in a cramped storage closet
- Enrollment is growing but, due to facility needs, our ability to deliver adequate programs is shrinking
 - The art and science classrooms will move onto carts, with their rooms converted to regular classrooms to accommodate growth
- None of our spaces have program-specific facilities for science, art, music or athletics

Adequate facilities are needed to deliver on programs and achieve our mission (1)

- Effective science education needs a laboratory with space, facilities and storage
 - In-depth study of science for elementary students
 - Provide hands-on activities
 - Make science inviting, colorful, exciting, engaging
 - Include models, computers and music
 - Provide manipulative materials: magnifying glasses, measuring tools, equipment, microscopes, seeds ...
 - Reinforce previous content with progressive, varying units
 - Provide proper safety attire

Allow our students to “become scientists”

Adequate facilities are needed to deliver on programs and achieve our mission (2)

- Effective arts education stretches students, allows them to express their individuality and to apply skill and imagination
 - A comfortable, well-lit space with supplies, storage for students' work, ample work space and sinks for clean up will allow students to create, experiment, and make mistakes
 - A safe environment frees students to be themselves and express their own views and experience
 - Space for an art library provides art history, artists biographies and examples of art
 - Art develops critical thinking and problem solving skills

Adequate facilities are needed to deliver on programs and achieve our mission (3)

- Effective music education requires specialized spaces
 - Noise conflicts with other rooms, including other music rooms; both classrooms and practice rooms are necessary
 - Substantial storage needs
- Smaller multipurpose rooms are needed for small groups of students, including ELL and those with disabilities
- Add K-1 classrooms to meet overwhelming demand from families, and to impact life outcomes for students
- Add air conditioning where feasible to allow Warren-Prescott to provide important summer programs
- Reconfigure the gymnasium currently used exclusively as the cafeteria to allow both uses, or provide other on-site facilities

The illustrative facility program demonstrates project feasibility



- ① Science lab, art classroom, library / computer lab, and K-1 classroom on two floors.
- ② Music classroom, music practice and ensemble rooms, and small group rooms on two floors.
- ③ Autism classroom, expansion of autism classroom, and specialist rooms on one floor.
- ④ Repair and update classrooms, corridors, lavatories, auditorium, heating and air conditioning, lighting, controls, and technology infrastructure. Improve energy efficiency.
- ⑤ Reconfigure gym currently used as the cafeteria to allow both uses, or provide other on-site facilities
-  Alternative locations for elevator(s) to provide accessibility.

Area ① facility program

New construction of 6,500 GSF on two levels above grade

- Science lab, 1,400 SF
- Art classroom, 1,300 SF
- Library / computer lab, 1,400 SF
- K-1 classroom, 1,300 SF, with restroom

New circulation connection to the main Warren-Prescott building.

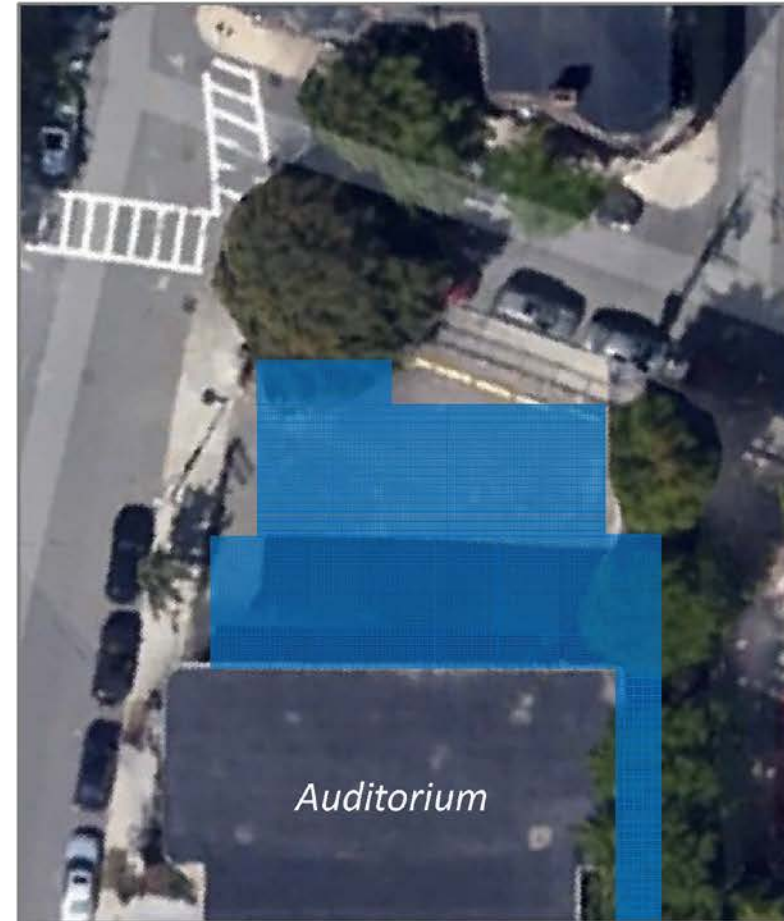

Area ② facility program

New construction of 3,700 GSF on two levels

- Music classroom 1,200 SF
- Music practice and ensemble rooms, 500 SF
- Small group rooms, 1000 SF total

Circulation connection to the main Warren-Prescott building at each floor level through existing corridors adjacent to site.

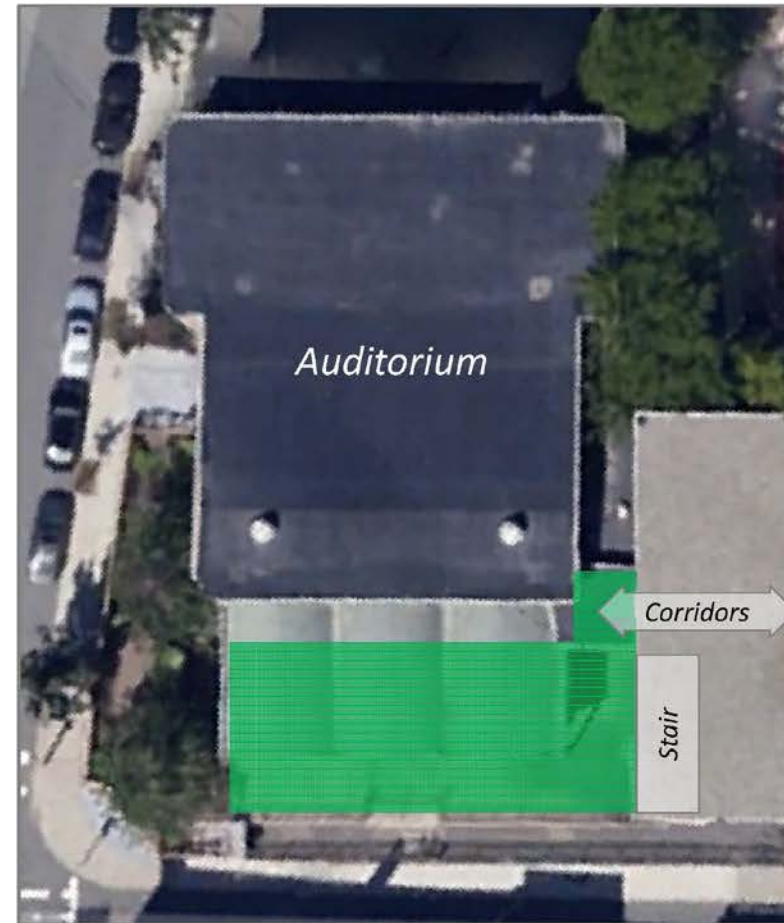

Area ③ facility program

New construction of 1,300 GSF on one level

- Autism classroom 900 SF
- Expansion of existing classroom 250 SF

One existing classroom converted to specialist rooms, circulation

Circulation connection to the main Warren-Prescott building through existing corridor.

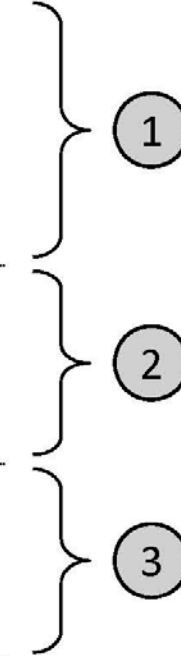

Summary of facility additions

- Science lab, 1,400 SF
 - Art classroom, 1,300 SF
 - Library / computer lab, 1,400 SF
 - K-1 classroom, 1,300 SF
 - Music classroom 1,200 SF
 - Music practice and ensemble rooms, 500 SF
 - Small group rooms, 1000 SF total
 - Autism classroom, 900 SF + 250 SF expansion
 - One existing classroom converted to specialist rooms, circulation
 - Supporting circulation, restrooms, accessibility improvements
- 
- 1
- 2
- 3

While these program needs and schematic design are not needed for an SOI, they illustrate the project's feasibility

Facility needs can be met without substantial disruption

- Repairs and expansion can be completed while Warren-Prescott operates normally:
 - Stage the renovation and construction
 - Location and timing of work moderates the construction impact
- Areas 1 and 2 are separated from the classrooms
- Area 3 projects are of modest scope; other new space might initially be used as swing space for the autism programs
- Repairs to main building can be done in stages to work around the school year and availability of new space
- This approach could be used by other Condition 3 and 4 schools

Warren-Prescott's renovation is urgently needed,
cost-effective, and ready to move forward

PRE-K - 8

Elementary Schools:

Academic Classrooms:

Basic building block for elementary education

900 – 950 square feet

Flexible furniture and environment

Capable of 1:1 Technology environment

Student Centric



PRE-K - 8

Elementary Art

1,200 square feet
Associated storage room
Associated kiln room

PRE-K - 8

Maker Spaces

PRE-K - 8

Learning Commons



21st Century Teaching & Learning



The 6 Rs

Reading Rigor
Writing Relevance
Arithmetic Relationship

The 4 Cs

- Critical Thinking
- Communication
- Collaboration
- Creativity

plus Citizenship

Head & Hand

Growth Mindset

- Student-Centered
- Interdisciplinary
- Technology-Infused
- Community Connected
- Problem- and Project-Based
- Process and Product Oriented

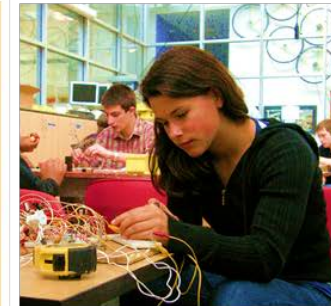

21st Century Spaces for Learning



- Changing Demographics
- School Organization
- Improved Science and Technology Spaces
- Incorporate Teacher Collaboration Areas
- 21st Century Teaching and Learning Methodologies
- Differentiated and Personalized Learning

School Environments

- Required
 - Supports The Educational Vision of the District
 - Learning Environments types and sizes (using MSBA criteria)
 - Enrichment Spaces
 - Support Spaces
- Strongly Recommended
 - Spaces and appointments that support: PBL; Differentiated and Personalized Learning; other delivery models
- Nice to Have
 - Maker Spaces

PRE-K - 8

Anytime/Anywhere Learning

PRE-K - 8

Alternative / Personalized / Special Education – Breakout Rooms



PRE-K - 8

Special Education: OT/PT



OT/PT Gross and fine motor skills

Resource Rooms & Small Group Rooms
vary from 500 – 1,000 Nsf

PRE-K - 8

Media Center / Learning Commons



PRE-K - 8

Secure Entry / Administration



PRE-K - 8

Outdoor Learning Environments

FOCUS ON
DISTRICT GOALS

USE POWERFUL
TOOLS

ENGAGE THE
COMMUNITY

PRE-K - 8

Enrichment: Art

Fielding Nair International, Architect



1,200 square feet
Associated storage room
Associated kiln room

PRE-K - 8

Gymnasium:

6,000 sf
Separate from cafeteria

PRE-K - 8

Outdoor Learning Environments



PRE-K - 8



Personalized



PRE-K - 8

Student Dining / Cafeteria / Stage



PRE-K - 8

Multi-Use Cafeteria



PRE-K - 8

Teacher Planning / Collaboration



PRE-K - 8

Enrichment: Music

1,200 SF
Acoustically isolated
Acoustically appropriate



PRE-K - 8

Academic Classrooms: PreK & K



1,100 sf Min – 1,300 SF max
w/ toilet room

PRE-K - 8

Special Education: Resource Room

Resource Rooms & Small
Group Rooms vary from
500 – 1,000 sf



PRE-K - 8

Outdoor Play



Questions for the BuildBPS team



Next Steps



Facility Physical Assessment



Barbara Deane-Williams, Lead Convener

Kim Rice, BPS

Al Taylor, BPS

Carleton Jones, BPS

Khadijah Brown, BPS

Brian Chambers, BPS

Mary Driscoll, BPS

Ramon Soto, Mayor's Office

Brian McLaughlin, PCMD

Austin Blackmon, Environment & Energy

Jonathan DePina, PCMD

Abi Vladeck, Budget

Paul Williams, Budget

TBD, DoIT

Nick Kraman, CPC

Joel Thompson, CPC

Richard Stutman, BTU

Phase II Team Educational Planning



Barbara Deane-Williams, Lead Convener

Rahn Dorsey, Chief of Education

Ramon Soto, Mayor's Office

Karla Estrada, BPS

Ryan Scallon, BPS

Mary Driscoll, BPS

TBD, Principal

Carleton Jones, BPS

Khadijah Brown, BPS

Mary McCoy, Budget

Brian McLaughlin, PCMD

TBD, SPEDPAC

Paul Tritter, BTU

TBD, BSAC

Heshan Berents-Weeramuni, CPC

Harneen Chernow, CPC

TBD, At-Large

Phase II Team Educational Assessment



Philip J. Poinelli, SMMA

Alex C. Pitkin, SMMA

Susan C. Zoller, MGT of America

Joe Clark, MGT of America

David Stephen, New Vista Design

SITE PLAN

Warren-Prescott School

